

14 November 2024

WFH Properties Limited
C/O Nigel Low
PO Box 501
Silverdale
Auckland 0944

Dear Owner/Developer,

Allocation of address – 91 Skulander Crescent

We advise you of the property addresses for the above property/development are as follows: specified on the attached plan.

Lot/Unit, DP number / Description	Street Address Allocated
8	22 Skulander Crescent
9	24 Skulander Crescent
10	26 Skulander Crescent
11	28 Skulander Crescent
12	30 Skulander Crescent
13	32 Skulander Crescent
14	34 Skulander Crescent
15	36 Skulander Crescent
16	38 Skulander Crescent
17	40 Skulander Crescent
18	42 Skulander Crescent
52	91 Skulander Crescent
53	93 Skulander Crescent
54	95 Skulander Crescent
55	97 Skulander Crescent
56	99 Skulander Crescent
57	101 Skulander Crescent
58	103 Skulander Crescent
59	105 Skulander Crescent

60	107 Skulander Crescent
61	109 Skulander Crescent
6000	111 Skulander Crescent

Please note that any plan amendments prior to the plan depositing, may affect the addresses allocated

Please ensure:

- 1) The address displayed on any mailbox or signage is changed or repositioned, if necessary, to an appropriate place on the property. It must be visible from the road to assist emergency services, New Zealand Post, and utility services.
- 2) Displayed numbers on letterboxes, are at least 25mm high.
- 3) If your property is on a corner site, the mailbox is placed on the correct road, main access point. Refer to section 5.8.3 of the AS/NZS 4819:2011 addressing standards and guidelines.
- 4) Where your property is leased or tenanted, it is your responsibility to advise the occupants of the street address

Auckland Council allocates street numbers under section 319B of the Local Government Act 1974 and the current New Zealand and Australian addressing standards.

<https://www.linz.govt.nz/regulatory/property-addressing/addressing-standards-and-guidelines>

If you have any concerns or queries regarding the above information, please contact me on acpropertyinformation@aklc.govt.nz

Yours faithfully

Paul Redman
Property Information Technician

Diag. A

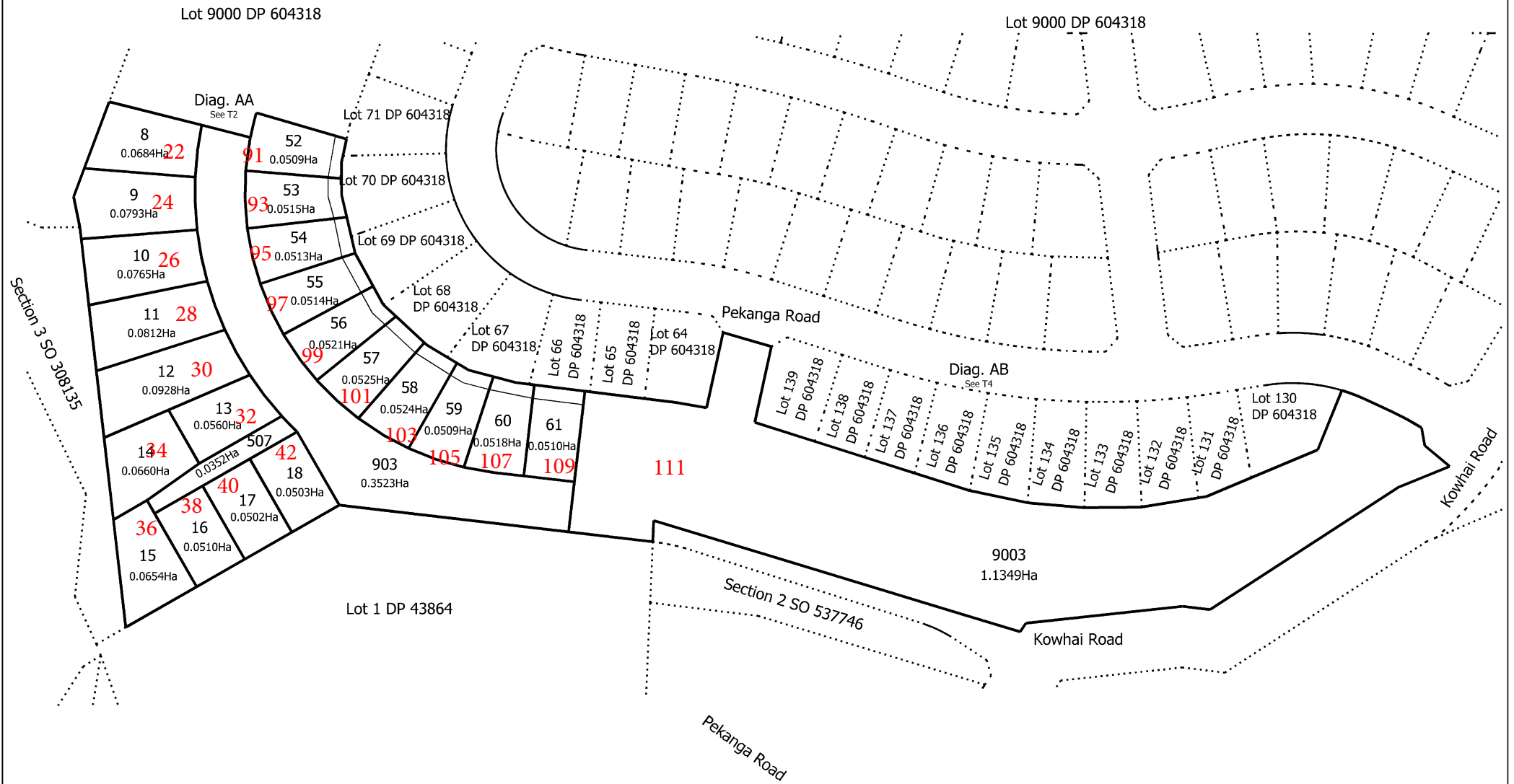
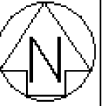

Note: Lot 903 hereon to vest on Deposit as Road in the Auckland Council.
Subject to Part 4A of the Conservation Act

T 1/4

Land District: North Auckland

LOTS 8-18, 52-61, 507, 903 AND 9003 BEING A SUBDIVISION OF LOT 9000
DP 605594

Surveyor: Kendall Lisa Reid

Firm: Wood & Partners Consultants Ltd

Title Plan
LT 611110
DRAFT

Digitally Generated Plan

Generated on: 28/10/2024 1:51pm Page 4 of 7